

AI Outdoor Parking Management Pro Bullet Plus Camera



DATASHEET



INTRODUCTION

Milesight AI Outdoor Parking Management Pro Bullet Plus Camera is designed for outdoor parking management. High-accuracy outdoor parking space detection based on AI algorithm enables simultaneous detection and management of up to 100 parking spaces. Besides, excellent scene adaptability realizes 24/7 parking management surveillance to help guide parking for more efficient and intelligent parking management. Make parking easy and smart!

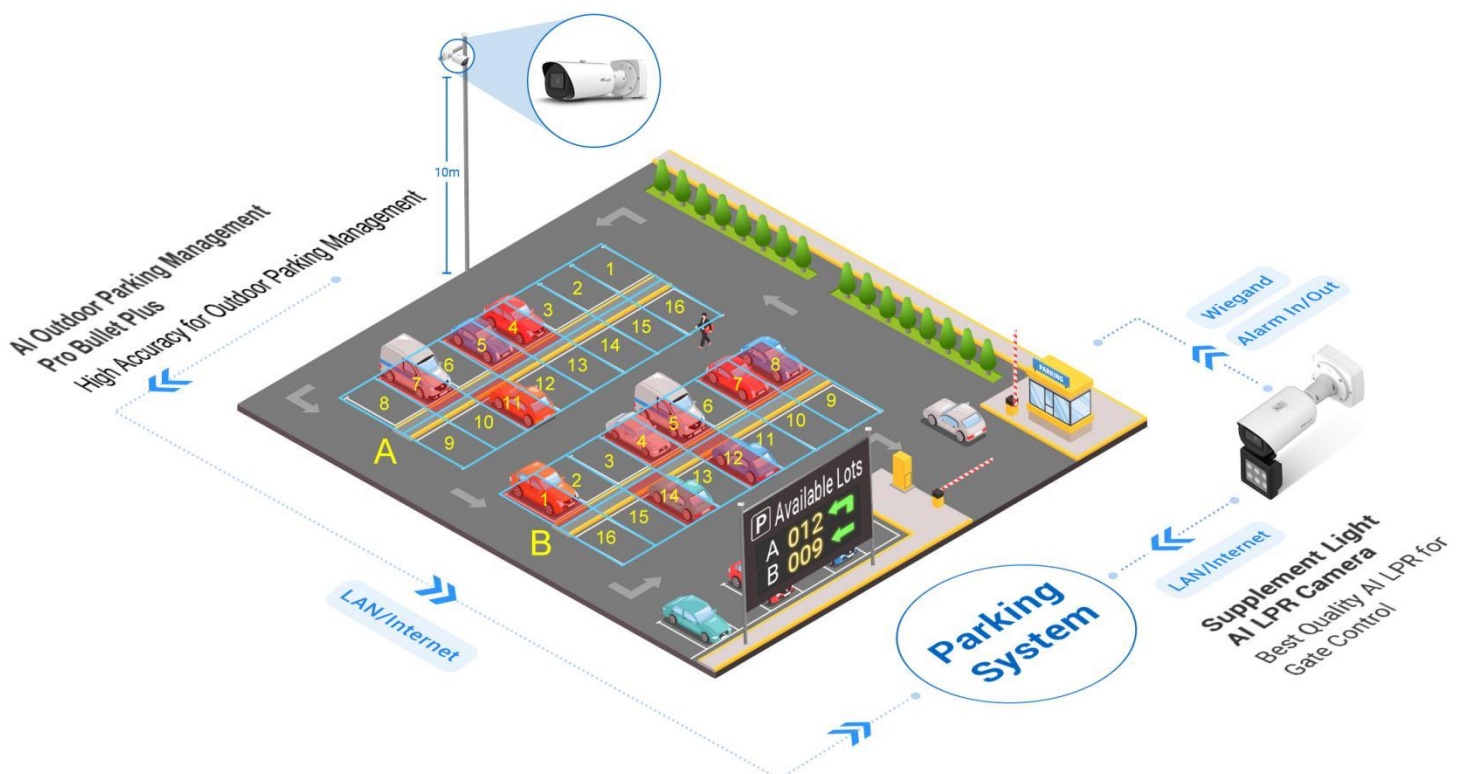

AI Outdoor Parking Management Pro Bullet Plus Camera



KEY FEATURES

Intelligent AI Parking Space Detection Algorithm

High-accuracy outdoor parking space detection based on AI algorithm can realize simultaneous detection and management of up to 100 parking spaces with up to 98% detection accuracy, which greatly helps guide parking and realizes more efficient and intelligent parking management.



Intelligence AI Algorithm



Up to 100 Parking Spaces Management



High Accuracy



Excellent Scene Adaptability

With a series of cutting-edge image technologies, AI Outdoor Parking Management has excellent scene adaptability. The wide field of view of the motorized zoom lens allows for a wider monitoring range, while the 4K resolution ensures that the images are sharp enough. In addition, under the 1/1.8" STARVIS starlight sensor and image-based frame accumulation technology, it also ensures the detection of parking lots at night, providing 24/7 surveillance monitoring.

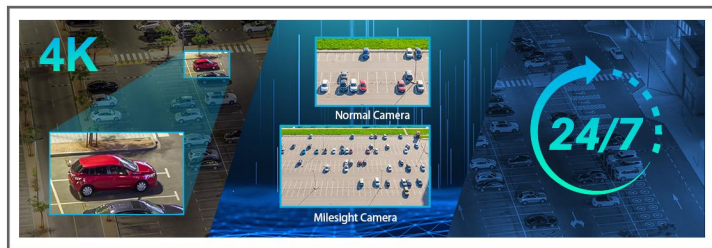

High compatibility

To maximize the usability and compatibility, the AI Outdoor Parking Management Camera supports CGI/APIs, which allows the easy open integration with third-party platforms. The network protocol such as HTTP(s) offers a wide range of options for data processing. The parking information is transmitted to the third-party parking system to help form a complete set of solutions, guide the driver to find the parking space quickly and realize intelligent management.



Unique Structure Design

The unique structure design of the camera enlarges the space and greatly saves efforts for installers, such as the integrated cable management bracket of Pro Bullet Plus Camera. And the IP67-rated weather proofing and IK10-rated vandal proofing allow to protect the camera against adverse impacts to ensure the robust performance.



Flexible Configuration

The configuration of Parking Space Detection is very flexible and convenient. Area Name, Planned Spaces of Area, Distribution and Numbering Scheme of the detection area can be customized, which provides a easy detection area configuration method and conforms to user habits. And the red overlay of the occupied parking space provides a more intuitive interface.

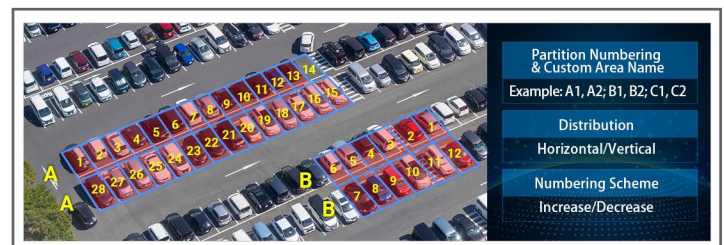

OBTAIN
THE USER MANUAL

AI Outdoor Parking Management Pro Bullet Plus Camera



| Camera | Name | PMC8266-FPC (4K) |
|--------------------------|-------------------------|--|
| | Image Sensor | 1/1.8" Progressive Scan CMOS |
| | Min. Illumination | Color: 0.009Lux@F1.4 B/W: 0Lux with IR on |
| | WDR | 120dB Super WDR |
| | Shutter Time | 1/100000s~1s |
| | IR Distance | Up to 65m |
| | Day/Night Mode | Day/Night/Auto/Customize/Schedule |
| | S/N | >55dB |
| Parking Space Management | Parking Space Detection | Up to 100 Parking Spaces@10m |
| | Detection Accuracy | >98% |
| | Data Report | Triggered Report: when parking space is occupied or released; Interval Report: regular report of entire parking situation |
| | Mounting Height | >3.5m |
| Lens | Lens | Motorized 3.6~10mm@F1.4 |
| | Field of View | H116°~H48°/D134°~D55°/V65°~V27° |
| | Mount | Φ14 |
| | Focus Control | Auto/Manual |
| Video | Max. Image Resolution | 3840x2160 |
| | Primary Stream | 60Hz: 30fps@(3840x2160, 3072x2048, 2592x1944, 2592x1520, 2048x1536, 1920x1080, 1280x960, 1280x720, 704x576) 50Hz: 25fps@(3840x2160, 3072x2048, 2592x1944, 2592x1520, 2048x1536, 1920x1080, 1280x960, 1280x720, 704x576) |
| | Secondary Stream | 60Hz: 30fps@(704x576, 640x480, 640x360, 352x288, 320x240, 320x192, 320x180) 50Hz: 25fps@(704x576, 640x480, 640x360, 352x288, 320x240, 320x192, 320x180) |
| | Tertiary Stream | 60Hz: 30fps@(1920x1080, 1280x720, 704x576, 640x480, 640x360, 320x240, 320x192, 320x180) 50Hz: 25fps@(1920x1080, 1280x720, 704x576, 640x480, 640x360, 320x240, 320x192, 320x180) |
| | Video Compression | H.265*/H.265(HEVC)/H.264*/H.264/MJPEG |
| | Video Bit Rate | 16Kbps~16Mbps(CBR/VBR Adjustable) |
| | | |
| Video | Privacy Masking | Up to 28 areas(24 mask areas and 4 mosaic areas) |
| | ROI | Up to 8 areas |
| | Image Setting | Brightness/Contrast/Saturation/Sharpness |

AI Outdoor Parking Management Pro Bullet Plus Camera



| | | |
|------------------|----------------------|--|
| Interface | Ethernet | 1*RJ45 10M/100M Ethernet Port |
| | Audio I/O | 1/1 |
| | Alarm I/O | 1/1 |
| Network | Network Storage | NAS(Support NFS, SMB/CIFS), ANR |
| | Protocol | IPv4/IPv6, ARP, TCP, UDP, RTCP, RTP, RTSP, RTMP, HTTP, HTTPS, DNS, DDNS, DHCP, FTP, NTP, SMTP, SNMP, UPnP, Bonjour, SIP, PPPoE, VLAN, 802.1x, QoS, IGMP, ICMP, SSL |
| Audio | Audio Compression | G.711/AAC/G.722/G.726 |
| | Audio Sampling Rate | 8/16/32/44.1/48KHz |
| | Audio Bit Rate | 16~256kbps |
| | Two-way Audio | Support |
| System | Storage | microSD/SDHC/SDXC Card Local Storage, up to 256G |
| | Advanced Function | BLC, HLC, 2D DNR, 3D DNR, Defog, AWB, EIS, IP Address Filtering, AGC, Anti-flicker, Corridor Mode, Deblur, Watermark |
| | SIP/VoIP Support | Yes, Voice & Video-over-IP |
| | Event Trigger | Motion Detection, Network Disconnection, External Input, Audio Alarm, etc. |
| | Event Action | FTP Upload, SMTP Upload, SD Card Record, External Output, SIP Phone, HTTP Notification, etc. |
| | System Compatibility | ONVIF Profile G & Q & S & T, API |
| General | Working Temperature | -40℃~60℃ |
| | Working Humidity | 0~90%(Non-condensing) |
| | Power Supply | PoE (802.3af) / DC 12V±10% |
| | Power Consumption | 8W MAX 17W MAX (With IR on) |
| | Housing | Vandal-proof IK10-rated Metal Housing / Up to IP67-rated for Weather-resistant Performance |
| | Surge Protection | 4KV |
| | Weight | 1630g |
| | Dimensions | 301mmX108mmX126mm |
| | Warranty | 3/5 Years |

AI Outdoor Parking Management Pro Bullet Plus Camera



Structure Diagrams

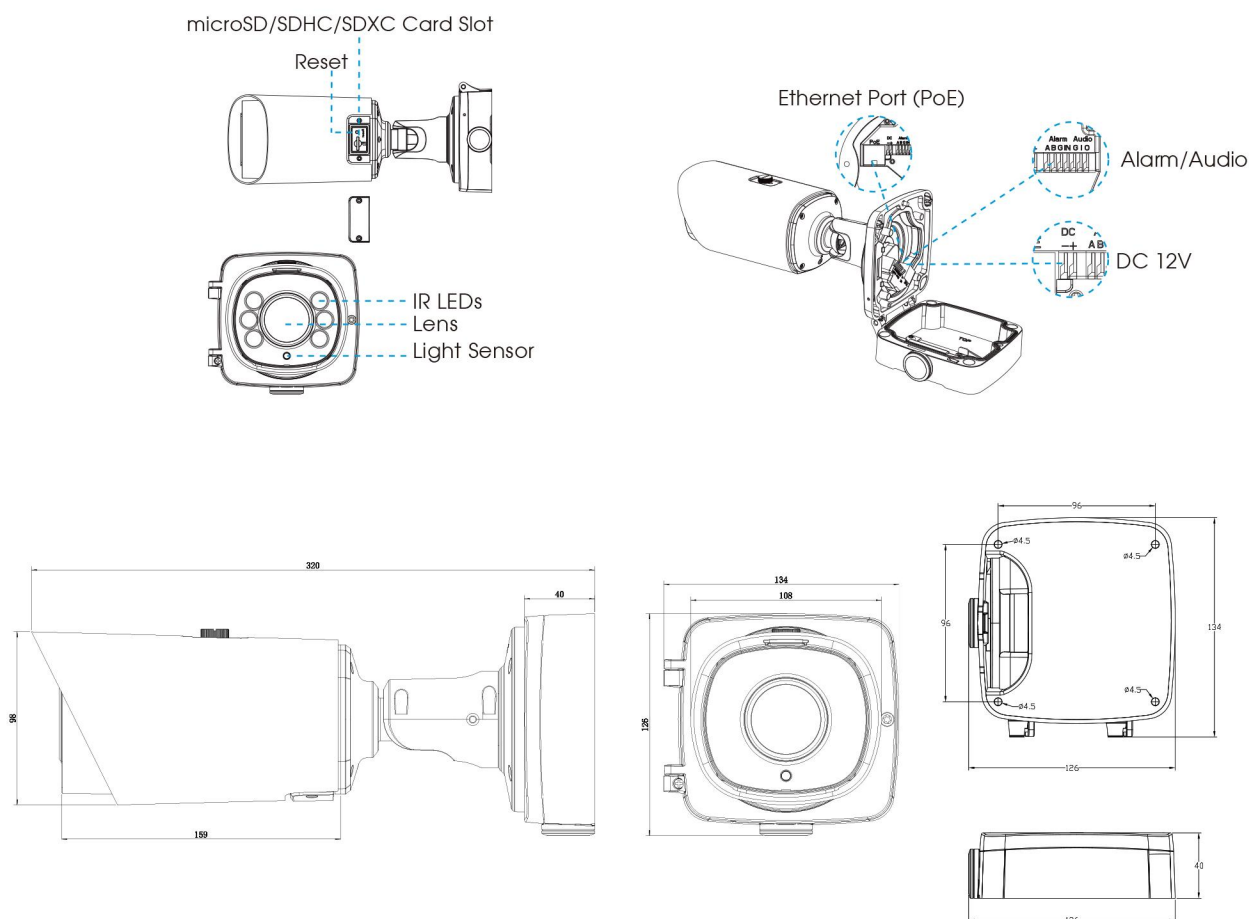

Units: mm

Accessories Support

A62 Junction Box(Default)

Weight: 510g
Dimensions: 134*126*40mm



A01 Pole Mount

Weight: 720g
Dimensions: 170*51.5*152.6mm



A03 External Corner Bracket

Weight: 900g
Dimensions: 170*152.5*76.3mm



Milesight Technology | www.milesight.com
Contact Us: sales@milesight.com support@milesight.com

Add: 220 NE 51st Street, Oakland
Park, Florida 33334, USA
Tel: +1-800-561-0485

Add: 925, Anyang SK V1 Center, LS-ro
116beon-gil, Dongan-gu, Anvng-si, Korea
Tel: +82-31-990-7732

Add: Building C09, Software Park
Phase III, Xiamen 361024, Fujian, China
Tel: +86-592-5922772

